

WALLU

architectural frame solutions

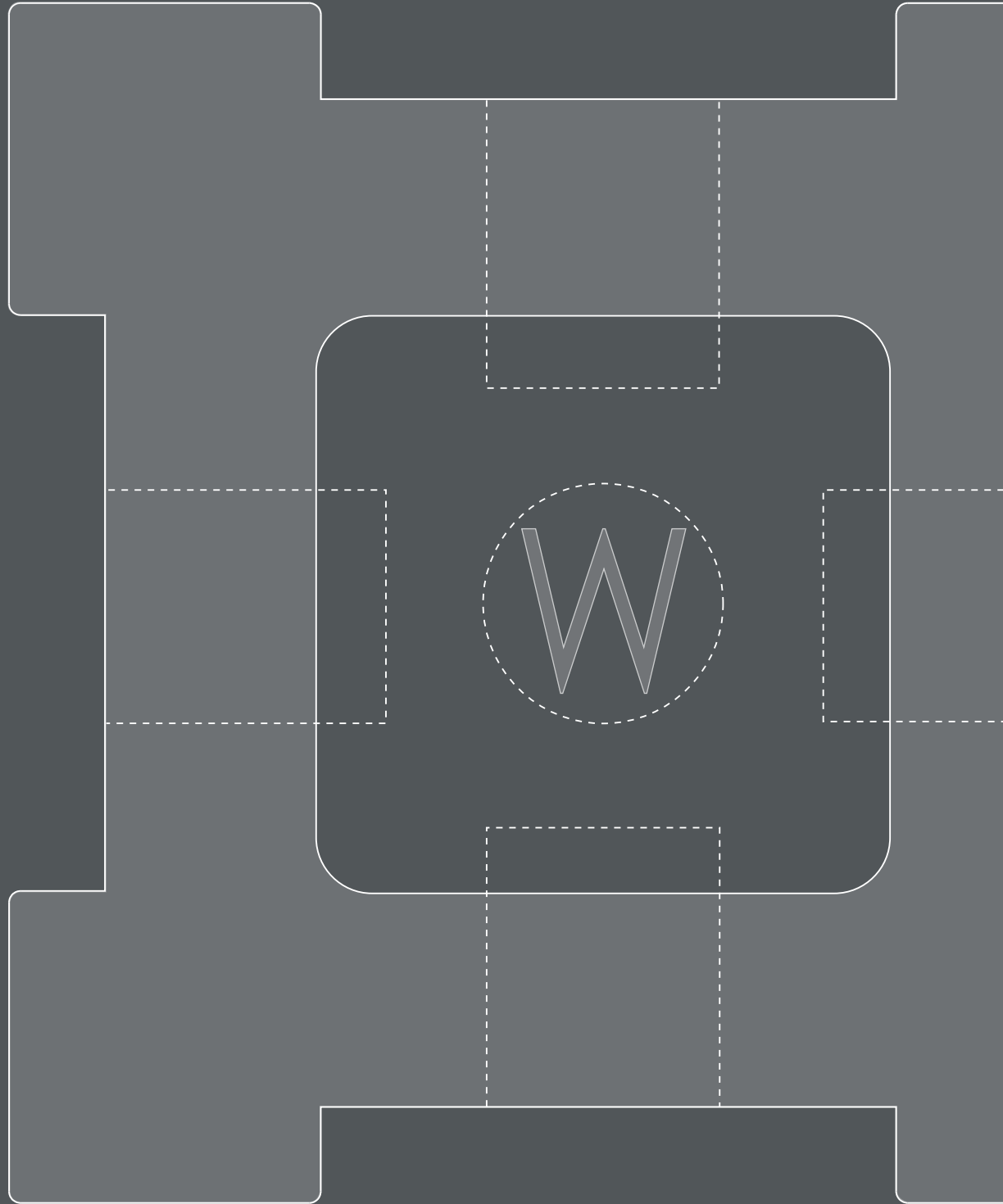

HIGH QUALITY ALUMINUM SYSTEM

easy to built reusable
modular components

flexible environmental friendly

WALLU
architectural frame solutions

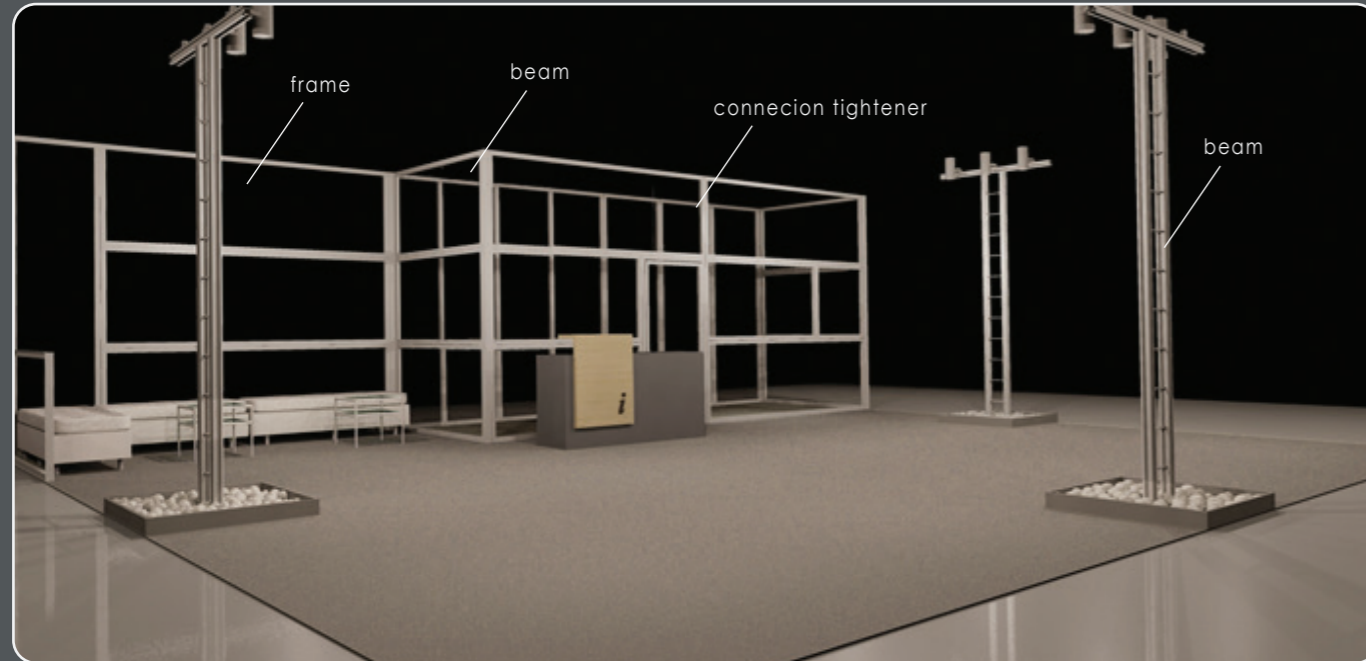

WALLU, few components, innumerous solutions

WALLU is a contemporary modular construction system and a necessary tool for designers and contractors to realize their inspirations in a quick, flexible and creative way. Its' main philosophy is to use few types of components , mainly frames, beams and connectors, that can be utilized in multiple ways to shape a space, almost like a game. The light weighted WALLU system, offers a solid yet invisible structure of ashtonishing simplicity.

You will be surprised by the innumerous combinations that WALLU components can form and therefore, the range of applications it can offer. WALLU can be used in any application that requires modular construction techniques like exhibition stands, interior design, display units, advertising, light boxes and many more.



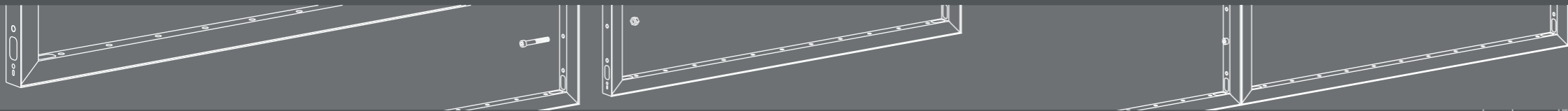

Using WALLU, allows you to shape at a minimum of time an invisible structure and cover it later by different types of panels, that meet your design requirements.

Almost any design can be formed with accuracy by the innumerus combinations of frames and beams you can choose.

All frames can be easily dismantled themselves, providing the ability to switch sides between different sized frames. This interchangeability feature multiplies the combinations your material in stock can provide.

As the constructive elements always stay in the background, the unlimited range of paneling surfaces, graphic options and internal lighting, allow you to produce creative solutions that meet modern disciplines of exhibiting and embrace your personal aesthetic and design.

When double faced walls are needed, adequate space for cabling is provided between panels. That is why WALLU system has also many applications in office spaces, providing a nice and easy installation of light separation walls.

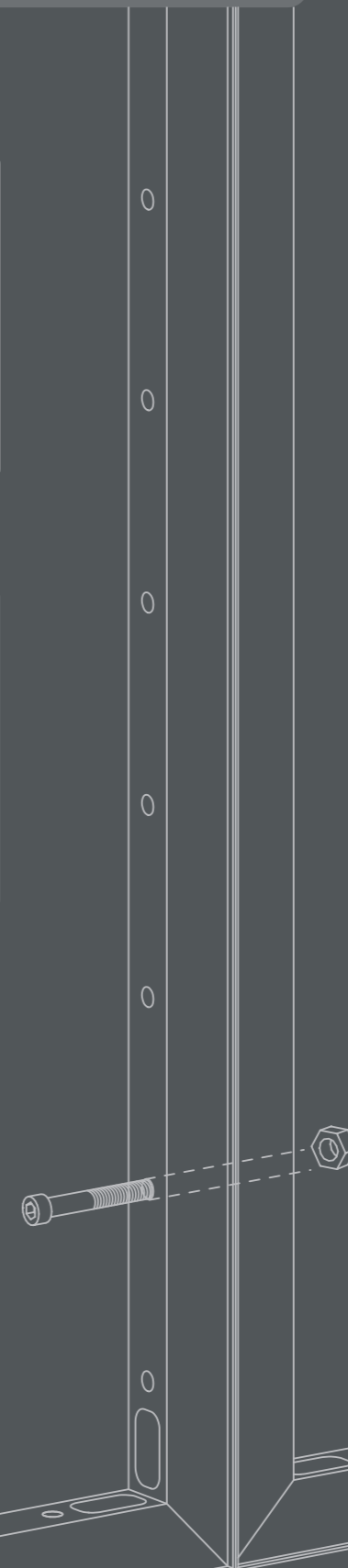
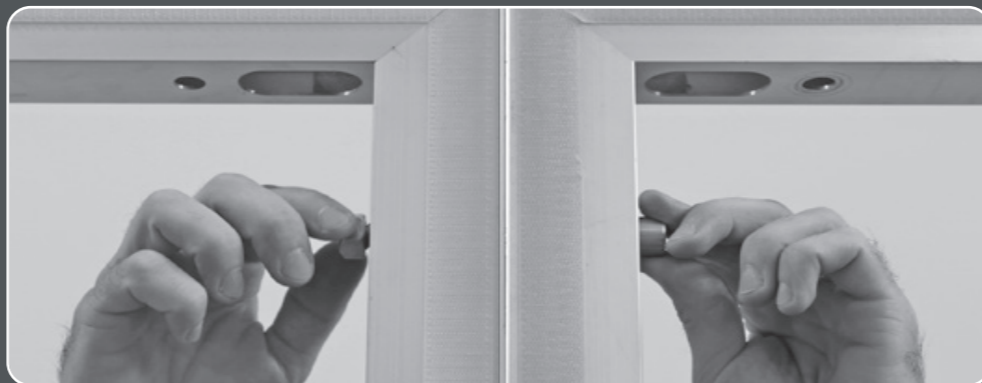
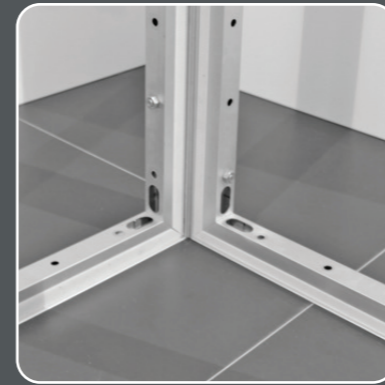
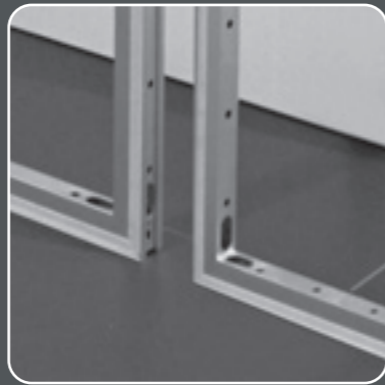



As the structure behind panels can be reconfigured time and time again to serve multiple exhibition needs, the look of your stand may be altered simply by using different paneling, graphics or materials.



The innumerable possible combinations of materials, colors and sizes among the WALLU paneling range, reflects a contemporary approach to exhibit design and offers a custom-built feel with all the benefits of a modular system.



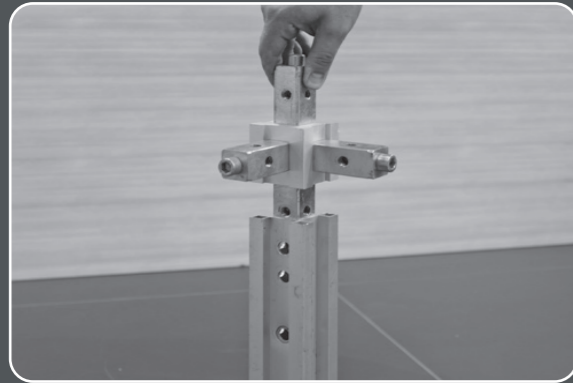

A good example of WALLU 's multi-functional feature is the node connector. It can be used in many ways, as a node to beam connector, as beam to beam connector, or simply to attach lighting fixtures to a beam or frame.



The node connector is not the only component that can be used in several ways. WALLU beams can double their height for bigger spans by simply connecting one on top of another.



Actually most of the WALLU components are designed base in one philosophy :

Fewer components, innumerus solutions !

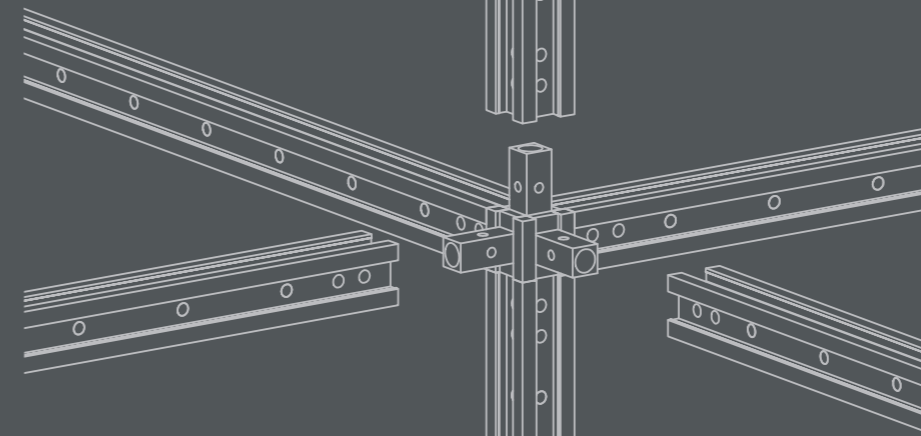



WALLU is designed as a construction system of multifunctioned components, therefore most of the elements perform more than one use. The multiple use feature and the high level of interchangeability WALLU provides, will benefit the contractor with the significant reduction of material in stock (also meaning less cost, storage and logistics expenses), the increased productivity of employees and finally the increased profitability over capital spent.

WALLU is also an ecological solution. Embedding high level of reusability and durability, can serve the need of the trade fair and exhibition industry for a low environmental footprint.

Most of all, WALLU is a highly aesthetic contemporary concept of modular construction, a tool in hand for the exhibition contractor. Its' proven consistency in detailing and adaptation in design requirements can only satisfy you and your clients.

So go ahead, unleash your invisible potential ! Join WALLU now !



WALLU

architectural frame solutions

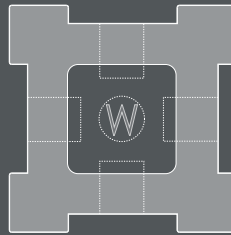

EXSITE - P. Andronikos & Co. E.E

12, Ntalias str. GR 136 77, Athens-Greece

Tel. +30210 4924100, Fax. +30210 4838507, e-mail: info@exsite.gr